

# Heater controls

CI/SfB

56

TS 212

## Thermostats

Most of our heaters can be supplied with integral thermostats, they are activated by the temperature sensed close to the heater. A more accurate control of the environmental temperature is achieved with a remote thermostat some of which have additional features to give a more energy efficient installation.

### CRST16 Interior Room Thermostat

Range +10°C/+30°C  
Rating 16A 230Vac  
Protection class IP20

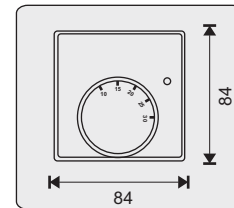

### CTRT Tamperproof Interior Room Thermostat

Range +6°C/+30°C  
Rating 16A 230Vac  
Protection class IP20

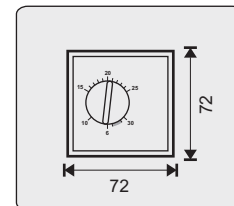

### CFST Interior Frost Thermostat

Range -5°C/+15°C  
Rating 16A 230Vac  
Protection class IP20

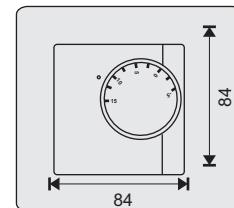

### CXFST Exterior Frost Thermostat

Range -5°C/+25°C  
Rating 10A 230Vac  
Protection class IP65

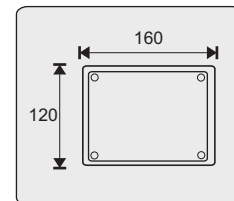

### CPRST Programmable Interior Room Thermostat

Weekday/Weekend operation  
4 on/off settings per day  
Fixed Frost protection setting  
Permanent on/off or timed selection  
Range +5°C/+35°C  
Rating 5A 230Vac  
Protection class IP20

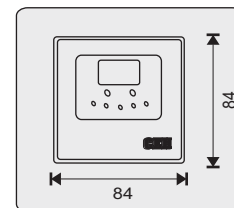

### CPRSTW Programmable Wireless Room Thermostat

433 MHz RF Control 100m open site range  
LCD Display  
Weekday/Weekend operation  
4 on/off settings per day  
Fixed Frost protection setting  
Permanent on/off or timed selection  
Range +5°C/+35°C Rating 16A 230Vac  
Protection class IP20

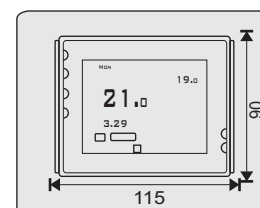

## Time controllers

### CTCM Electro Mechanical Time controller

24 hour or 7 day operation  
Manual override and permanent on/off  
10 on /10 off settings per 24 hour period  
20 minutes minimum switching interval for 24 hour operation  
2 hour minimum switching interval for 7 day operation  
Single pole volt free contacts.  
Rating 20A 230Vac  
Protection class IP20

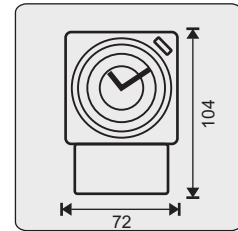

### CTCD DigitalTime controller

24 hour - 7 day,  
Easy text oriented programming with battery back up.  
Manual override and permanent on/off  
21 on /21off settings per 7day period  
1 minute minimum switching period  
Change over volt free contacts.  
Rating 16A 230Vac  
Protection class IP20

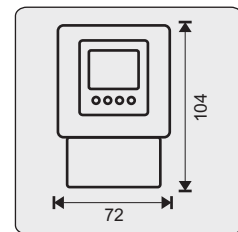

### CTTF 7 day Fused Time controller

Incorporates 13A fused connection unit fitting to single gang wall box(25mm)  
Easy two button programming with battery back up.  
Manual override and permanent on/off  
21 on /21off settings per 7day period  
1 minute minimum switching period  
Single pole volt free contacts.  
Rating 13A 230Vac  
Protection class IP20

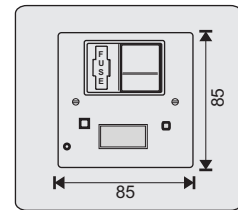

## PIR Controller

### CPIR Passive Infra Red movement sensor

12m detection range with 180° area of detection  
Adjustable ON time 5 sec to 12 mins  
Manual ON/OFF override  
Rating 16A 230Vac  
Protection class IP44

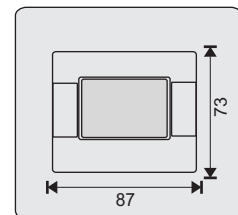

The manufacturers reserve the right to change the specification without prior notice E&OE



Commercial Electric Heat Limited  
Unit 712 Thorp Arch Trading Estate  
Wetherby West Yorkshire LS23 7BJ  
Tel 01937 844994 Fax 01937 844123  
www.cehltd.co.uk  
email sales@cehltd.co.uk